

G-L-T

DESIGN 4 PROFESSIONAL

D-2 UNIT PACK RF



Instructions for use

D-2 UNIT PACK RF

Content

Features 1

General Instructions 2

1. Overview 3

1.1 Front panel 3

1.2 Back panel 4

2. Use 5

2.1 DMX Address Mode 5

2.2 Switch Pack Mode 6

2.3 Dimmer Pack Mode 7

Technical data 10

Features

Features of this product:

- DMX 512 In/Out 3 pin XLR plug
- SWITCH pack or DIMMER pack mode (on/off / dimming)
- Backup of states in the event of a power failure
- 4 digit screen.

General instructions

Please read this manual before installing or using your new product.

Safe to use

- This product must be grounded.
- Do not introduce water, flammable liquids or metal objects into the device.
- Be careful not to damage the power cord.
- Any intervention in this device must be carried out by qualified personnel.
- In the event of a malfunction (smell of burning, etc.), immediately stop operation, unplug the power plug, and contact the authorized service center.
- To prevent fire or shock hazard, do not expose this product to rain or moisture.

Precaution for use

- This product is intended for indoor use only.
- Provide occasional ventilation during use.
- Unplug the power plug from outlets when not in use.
not the device for an extended period of time.
- Do not use the device in locations exposed to moisture.
excessive or vibration.
- Place this device on a stable support.
- Do not disassemble or modify the device.

DMX Signal Cable: Use 110 ohm impedance DMX cable for signal connection.

1. Overview

1.1 Front panel

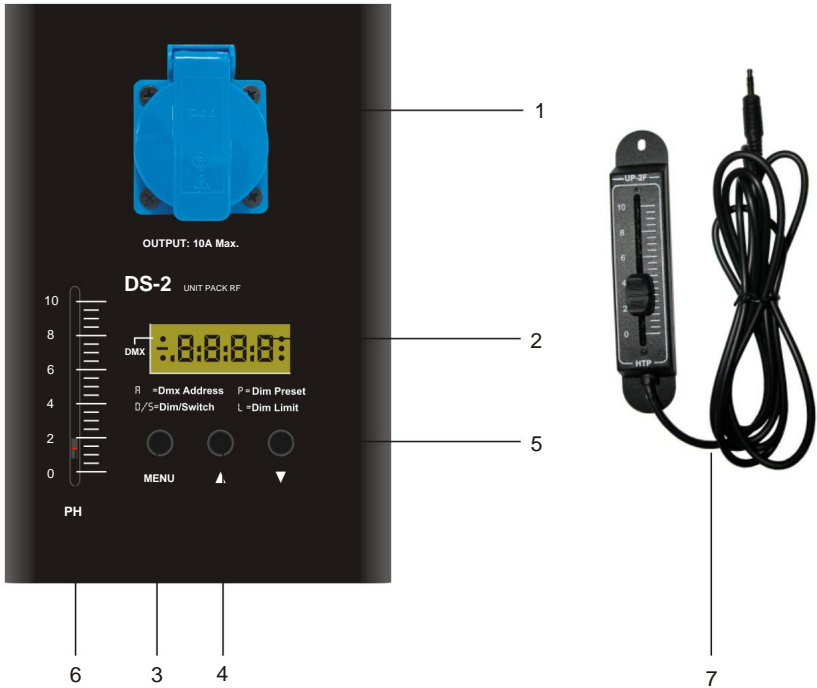

1. Output: 10A max.
2. Display: Displays current activity or function status.
3. Menu button 4. UP button: Press to go to the next level. Each press increases the value by one unit. Pressing and holding increases rapidly.
5. DOWN button: Each press decreases the value by one unit. Pressing and holding will decrease rapidly.
6. HTP Slider: This slider adjusts the intensity of the channel illumination and conforms to the HTP principle (Highest takes precedence).
7. Ext. Connected Slider: This slider has the same function as the HTP Slider (6).

1. Overview

1.2 Back panel

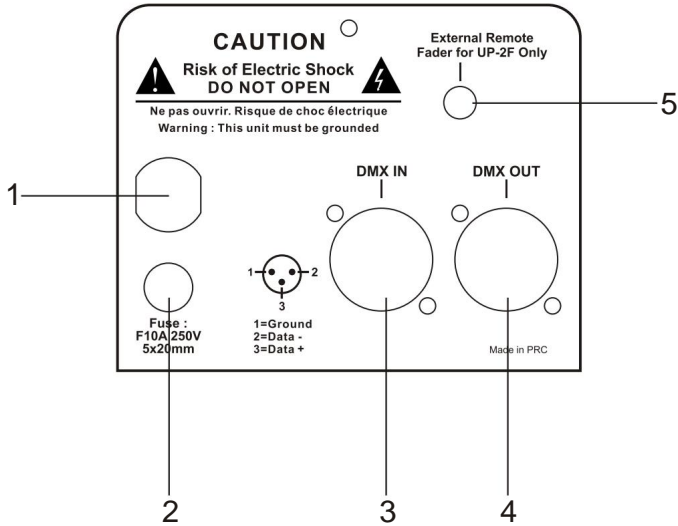

- 1. Power cord: 2. Fuse: Plug in the appropriate power outlet. F10A 250V 5x20mm
- 3. DMX In: 3-pin XLR male socket, used to receive DMX data.
- 4. DMX Out: 3-pin XLR female socket, used to send DMX data.
- 5. 3.5mm jack : External fader connection

2. Use

Nota Bene :

If the frequency of the electric current supplied to the device is not stable, the segment display will show "AC-0". Wait for the power to stabilize.

2.1 DMX Address Mode

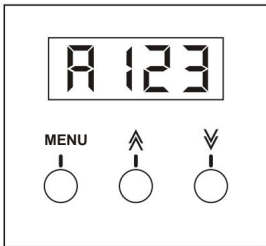

1. The display shows the last DMX address used.

If you last selected DMX address 123, the segment display will show 123.

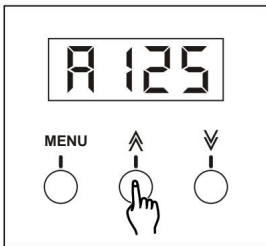

2. Each press of the UP or DOWN button changes the DMX address once. Press and hold to quickly change the DMX address.

Once the DMX address has been selected, it is automatically stored.

NOTE: When addressing DMX, the output is disabled.

2. Use

2.2 Switch Pack Mode

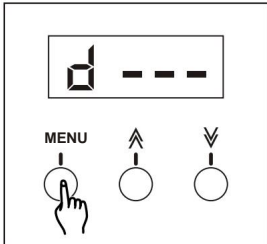

1. When the DMX address is selected, press the Menu key to move to the next level.

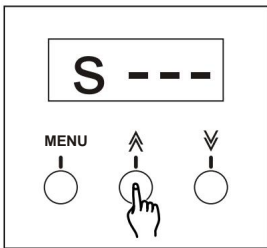

2. Press the UP or DOWN button until "s ---" is displayed.

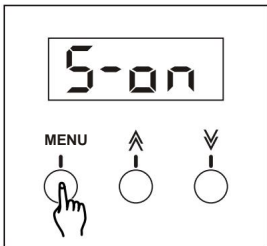

3. Press the Menu button to enter Switch Pack mode.

SWITCH pack mode consists of S-on and S-of.

In On mode, the output is activated and the fixture turns on regardless of the DMX signal.

In off mode, the output is deactivated and the luminaire is controlled by a DMX signal. When the DMX level is below 40%, the fixture will turn off; When the DMX level exceeds 40%, the fixture will turn on.

2. Use

2.2 Switch Pack Mode

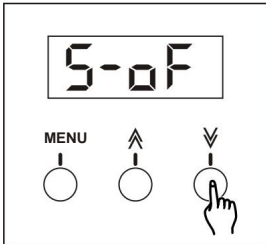

4. Press Up or Down button to toggle between Enable and Disable.

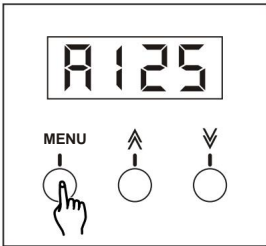

5. Once the Switch Pack is selected, press the Menu button to return to DMX Address mode.

2.3 Dimmer Pack Mode

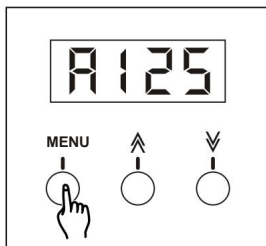

1. Press the Menu button to go to the next level.

2. Use

2.3 Dimmer Pack

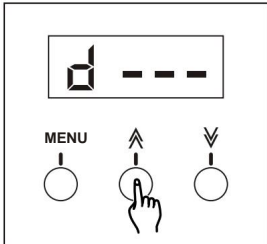

2. Press the UP or DOWN button until "d ---" is displayed.

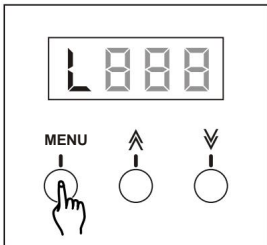

3. Press the Menu button to enter Dimming Limit mode.

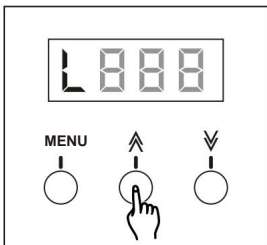

4. Press the UP or DOWN button to change the value between 10 and 100. Each press will change the value once, pressing and holding will change the value quickly.

Once the dimmer limit is selected, it is automatically stored.

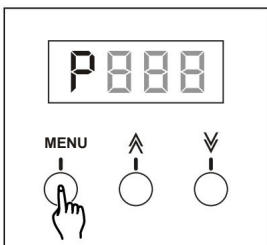

5. Press the Menu button to enter dimmer preset mode.

2. Use

2.3 Dimmer Pack Mode

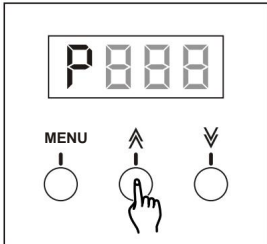

4. Press the UP or DOWN button to change the value between 00 and 100. Each press will change the value once, pressing and holding will change the value rapidly.

Once the dimmer preset is selected, it is stored automatically.

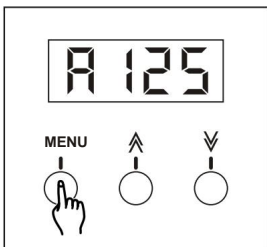

5. Press the Menu button to return to DMX Address mode

Technical characteristics

Feed AC 230V-50Hz, 10A max.

Channel output 10 A max.

DMX-OUT 3-pin XLR female socket.

DMX-IN 3 pin XLR male plug.

Fuse F10A 250V 5x20mm

Dimensions 182x92x65mm

Weight..... 1.1Kg

IMPORTER

B&K LUMITEC

2 rue Alfred Kastler
Zone Industrielle
67850 Herrlisheim - France

+33 (0) 3.88.96.80.90

+33 (0) 3.88.96.48.46

hello@bklumitec.com

www.bklumitec.com